

CONCRETE INSERTS

A selection of heavy-duty to light-duty “continuous” and “spot” concrete inserts is available for use in pre-cast, pre-stressed or poured-in-place concrete floors, walls or ceilings.

MATERIAL:

Power-Strut continuous slotted concrete inserts are cold formed from structural quality strip steel.

STANDARD LENGTHS:

Standard lengths are 10 or 20 feet. Non-standard lengths from 3 inches to 20 feet are also available.

STANDARD FINISH:

Power-Strut continuous-slotted concrete inserts are available in plain or pre-galvanized finishes. Closure strips (CS) are made of plastic and end caps (EC) are pre-galvanized.

ORDERING INFORMATION:

When ordering, add the length or size and finish to the part number. See pages 8-10 for finish abbreviations and an example.

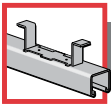

CONCRETE INSERTS

Finish: Plain, Pregalvanized or Hot-Dipped Galvanized **Stock Thickness:** .105 (12 ga.) **Stock Length:** 20 feet
 Other lengths made to order **Order By:** No. and Size

PS 349 – Continuous Concrete Insert (1⁵/₈" x 1³/₈"

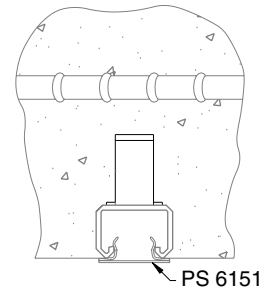
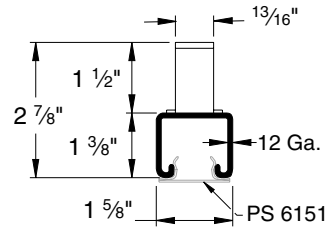
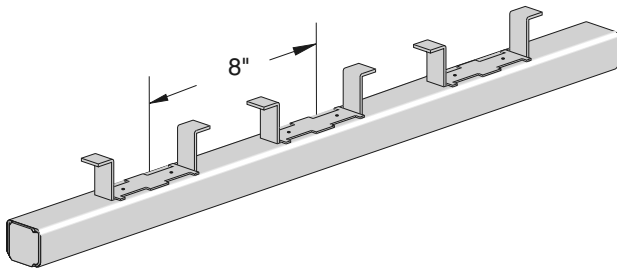

Choice of end cap is based on the distance from the end of the insert to the first anchor as shown below.

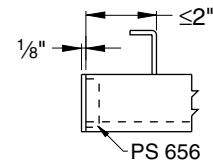
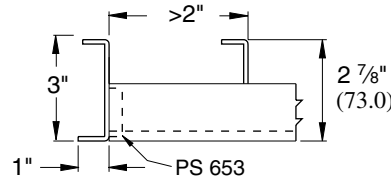
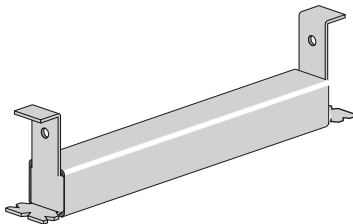

- Use channel nuts designed for PS 300 Channel.
- Nail or anchor the inserts to forms every 16" to 24"

Furnished with steel end caps and plastic closure strips installed

Part No.	End Cap	Wt./100 pcs		Load Data*
		PLN		
PS 349 3' CS/EC	PS 653	72		500 lbs
PS 349 4' CS/EC	PS 653	87		800 lbs.
PS 349 6' CS/EC	PS 653	117		1,000 lbs.
PS 349 8' CS/EC	PS 653	147		1,200 lbs.
PS 349 1' CS/EC	PS 653	194		2,000 lbs.
PS 349 1'4" CS/EC	PS 656	253		2,000 lbs./ft.
PS 349 1'8" CS/EC	PS 653	312		2,000 lbs./ft.
PS 349 2' CS/EC	PS 656	371		2,000 lbs./ft.
PS 349 2'8" CS/EC	PS 656	490		2,000 lbs./ft.
PS 349 3' CS/EC	PS 653	549		2,000 lbs./ft.
PS 349 4' CS/EC	PS 656	727		2,000 lbs./ft.
PS 349 5' CS/EC	PS 653	905		2,000 lbs./ft.
PS 349 6' CS/EC	PS 656	1,082		2,000 lbs./ft.
PS 349 7' CS/EC	PS 653	1,260		2,000 lbs./ft.
PS 349 8' CS/EC	PS 656	1,438		2,000 lbs./ft.
PS 349 9' CS/EC	PS 653	1,615		2,000 lbs./ft.
PS 349 10' CS/EC	PS 656	1,793		2,000 lbs./ft.
PS 349 12' CS/EC	PS 656	2,148		2,000 lbs./ft.
PS 349 14' CS/EC	PS 656	2,504		2,000 lbs./ft.
PS 349 16' CS/EC	PS 656	2,859		2,000 lbs./ft.
PS 349 18' CS/EC	PS 656	3,215		2,000 lbs./ft.
PS 349 20' CS/EC	PS 656	3,570		2,000 lbs./ft.
PS 349 10' W/O	Insert Only	1,777		*uniform recommended loading
PS 349 20' W/O	Insert Only	3,554		on inserts in 3,000 psi concrete.

CONCRETE INSERTS

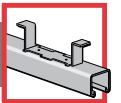

Finish: Plain, Pregalvanized or Hot-Dipped Galvanized **Stock Length:** 20 feet Other lengths made to order
Order By: No. and Size

PS 449 – Continuous Concrete Insert (1⁵/₈" x 1")

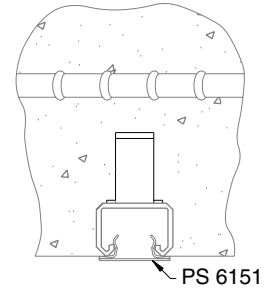
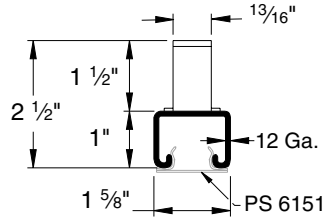
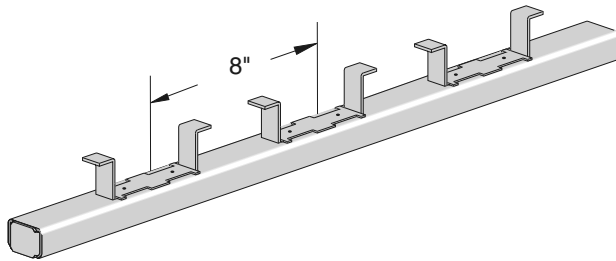

Choice of end cap is based on the distance from the end of the insert to the first anchor as shown below.

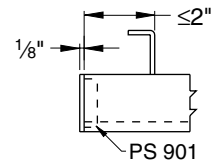
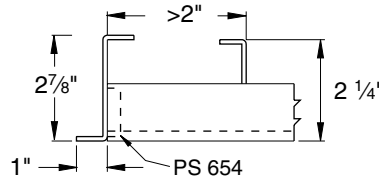
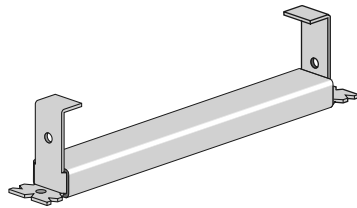

Furnished with steel end caps and plastic closure strips installed

Part No.	End Cap	Wt./100 pcs		Load Data*
		PLN		
PS 449 3" CS/EC	PS 654	62		500 lbs
PS 449 4" CS/EC	PS 654	74		600 lbs.
PS 449 6" CS/EC	PS 654	99		800 lbs.
PS 449 8" CS/EC	PS 654	124		1,000 lbs.
PS 449 1' CS/EC	PS 654	163		1,600 lbs./ft.
PS 449 1'4" CS/EC	PS 901	213		1,600 lbs./ft.
PS 449 1'8" CS/EC	PS 654	263		1,600 lbs./ft.
PS 449 2' CS/EC	PS 901	313		1,600 lbs./ft.
PS 449 2'8" CS/EC	PS 901	414		1,600 lbs./ft.
PS 449 3' CS/EC	PS 654	464		1,600 lbs./ft.
PS 449 4' CS/EC	PS 901	615		1,600 lbs./ft.
PS 449 5' CS/EC	PS 654	766		1,600 lbs./ft.
PS 449 6' CS/EC	PS 901	916		1,600 lbs./ft.
PS 449 7' CS/EC	PS 654	1,079		1,600 lbs./ft.
PS 449 8' CS/EC	PS 901	1,218		1,600 lbs./ft.
PS 449 9' CS/EC	PS 654	1,368		1,600 lbs./ft.
PS 449 10' CS/EC	PS 901	1,519		1,600 lbs./ft.
PS 449 12' CS/EC	PS 901	1,820		1,600 lbs./ft.
PS 449 14' CS/EC	PS 901	2,122		1,600 lbs./ft.
PS 449 16' CS/EC	PS 901	2,423		1,600 lbs./ft.
PS 449 18' CS/EC	PS 901	2,725		1,600 lbs./ft.
PS 449 20' CS/EC	PS 901	3,026		1,600 lbs./ft.
PS 449 10' W/O	Insert Only	1,507		*uniform recommended loading on inserts in 3,000 psi concrete.
PS 449 20' W/O	Insert Only	3,014		

- Use channel nuts designed for PS 400 Channel.
- Nail or anchor the inserts to forms every 16" to 24"

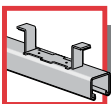

CONCRETE INSERTS

PS 656, PS 901 – Type 'A' End Cap

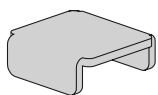

Part No.	Use With Insert	Finish	Wt./ 100 pcs
PS 656	PS 349	PGAL	8
PS 901	PS 449	PGAL	6

PS 653 – Type 'B' End Cap

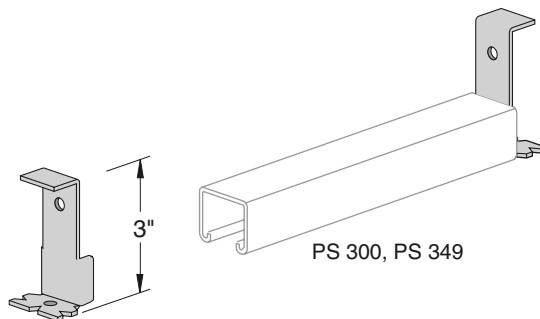

Finish: Pre-galvanized

Weight/100 pcs: 14 lbs.

PS 654 – Type 'B' End Cap

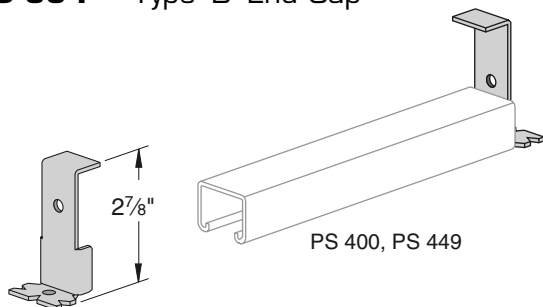

Finish: Pre-galvanized

Weight/100 pcs: 12 lbs.

PS 1154 – Splice Connection

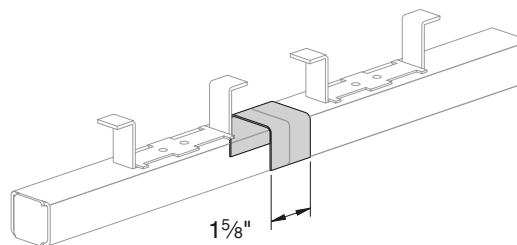

Use With: PS 349

Weight/100 pcs: 10 lbs.

PS 6151 – Plastic Closure Strip

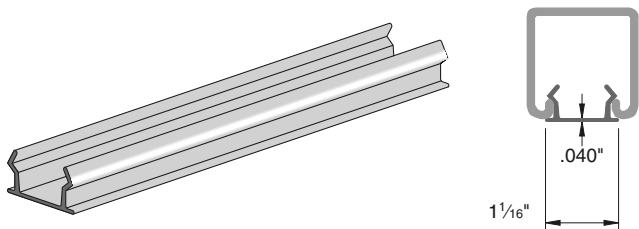

Material: Plastic

Stock Length: 10 ft.

Use With: All 1 5/8" channel and inserts to prevent concrete seepage

Weight/100 pcs: 47 lbs.

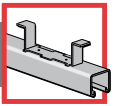

PS 285 – Light Weight Concrete Insert

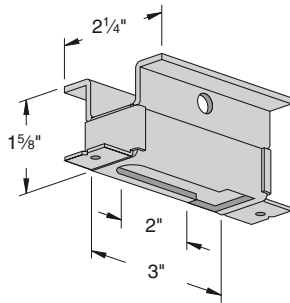

Rod Size	Load Rating	Wt./ 100 pcs
1/4"	230	46
3/8"	400	49
1/2"	400	49

Finish: Plain or Electro-galvanized

PS 285 N – Concrete Insert Nut (for use with PS 285)

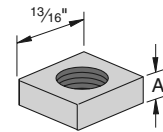

Part No.	Rod Size	A	Wt./ 100 pcs
PS 285	1/4"	5/16"	6
PS 285	3/8"	5/16"	5
PS 285	1/2"	7/16"	6

Finish: Plain or Electro-galvanized

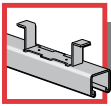

CONCRETE INSERTS

PS 680 – Concrete Deck Insert

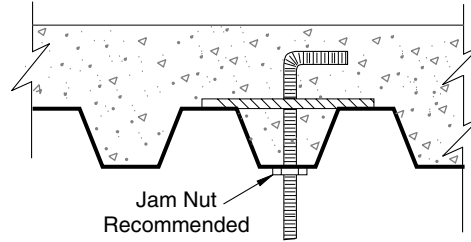
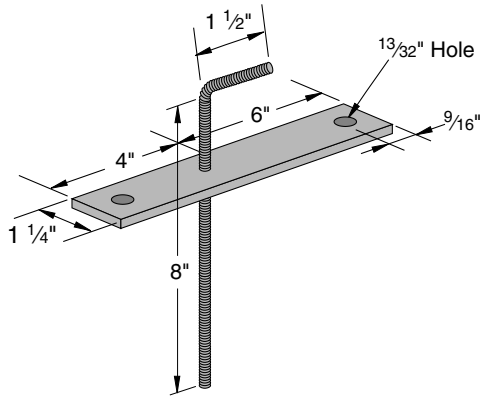

Note: Rod is electro-galvanized and plate is plain.

Part No.	Wt./ 100 pcs	Load Rating
PS 680- $\frac{3}{8}$ "	86	610
PS 680- $\frac{1}{2}$ "	105	1,130
PS 680- $\frac{5}{8}$ "	130	1,810

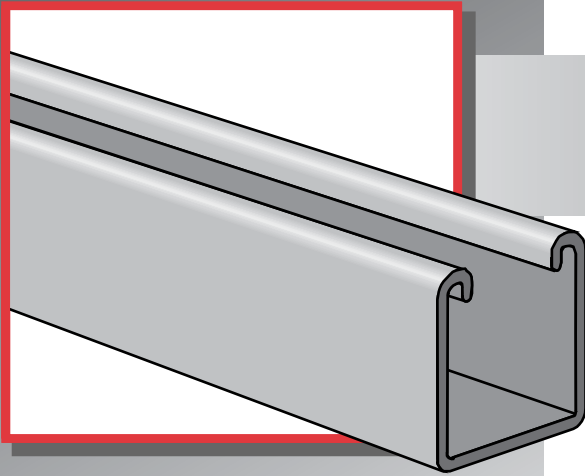

JUNIOR CHANNEL

Power-Strut junior channel sections are cold formed from prime quality cold rolled steel. Junior channel fittings are punched from hot rolled, pickled and oiled steel.

■ STANDARD LENGTHS:

Standard length is 10 feet at a tolerance of $\pm 1/16$ inches. Shorter lengths are available for a small cutting charge.

■ STANDARD DIMENSIONS FOR FITTINGS:

Fitting Thickness: $1/8$ "
Fitting Width: $13/16$ "
Hole Diameter: $9/32$ "
Hole Spacing: $1 1/16$ " on centers and $13/32$ " from end.

■ STANDARD FINISH:

PS 600J and PS 700J junior channels are available in a galvanized or painted green finish. All junior channel fittings are available in electro-galvanized finish.

■ ORDERING INFORMATION:

When ordering, add the length or size and finish to the part number. See pages 8-10 for finish abbreviations and an example.