

FASTENERS

Power-Strut Clamping Nuts are cold formed, with two grooves, each with six sharp teeth and then case hardened. These sharp hardened teeth bite into the inturned edges of the Power-Strut channel forming a strong vise-like connection giving greater strength and resistance to slippage.

MATERIAL:

Channel clamping nuts meet ASTM A576 GR1015M, and are case hardened. Hex head bolts meet SAE J429 GR 2 and ASTM A307. Square and hex nuts meet ASTM A563 GR A.

SCREW THREADS DATA:

All Power-Strut nuts and bolts are manufactured to meet the Unified Screw Threads standard, ANSI B1.1, Coarse Series UNC, class 2. Continuous Threaded Rod: Meets ASTM A-510.

STANDARD FINISH:

All fasteners have an electro-galvanized finish.





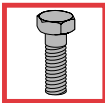

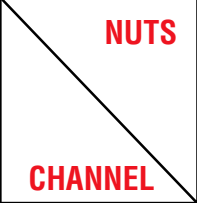

RECOMMENDED TORQUE:

Bolt Size	1/4"-20	5/16"-18	3/8"-16	1/2"-13
Foot Pounds	6	11	19	50

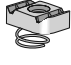
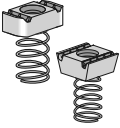
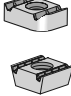

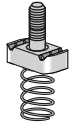
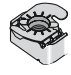
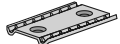
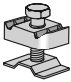
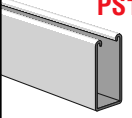
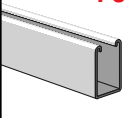
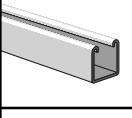
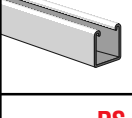
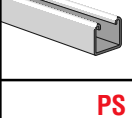
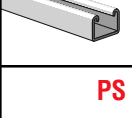
FASTENERS

Channel Nut Selection Chart

 NUTS CHANNEL	 PS LS	 PS SS	 PS RS	 PS NS	 PS NS S	 PS 517	 PS TG	 PS 3281	 PS 3500
	 PS100	✓			✓			✓	✓
 PS 150	✓			✓			✓	✓	
 PS 200			✓	✓		✓	✓	✓	✓
 PS 210			✓	✓		✓	✓	✓	✓
 PS 300			✓	✓		✓	✓	✓	✓
 PS 400		✓		✓	✓		✓	✓	
 PS 500		✓		✓*	✓		✓	✓	
 PS 520		✓		✓*	✓		✓	✓	
 PS 560		✓		✓*	✓		✓	✓	

✓ Indicates Nuts To Be Used With The Channel

* 3/8" or smaller

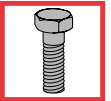

Finish: Electro-galvanized Order By: No. and Size and Finish

PS 6024 – Hex Head Cap Screw

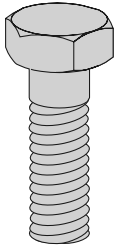

Size	Wt./100 pcs
1/4 x 3/4"	1.5
1/4 x 1"	1.8
1/4 x 1 1/4"	2.1
1/4 x 1 1/2"	2.4
3/8 x 3/4"	3.6
3/8 x 1"	4.2
3/8 x 1 1/4"	4.9
3/8 x 1 1/2"	5.6
3/8 x 2"	7.2
1/2 x 3/4"	8.1
1/2 x 1"	9.2
1/2 x 1 1/4"	10.4
1/2 x 1 1/2"	11.6
1/2 x 1 3/4"	13.0
1/2 x 2"	14.4

PS 6075 – Slotted Hex Head Machine Screw

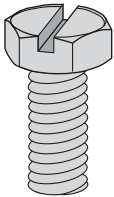

Size	Wt./100 pcs
1/4 x 3/4"	1.7
5/16 x 1"	2.6
5/16 x 1 1/4"	3.0
5/16 x 1 1/2"	3.4
3/8 x 1 1/4"	5.3

PS 6072 – Round Head Machine Screw

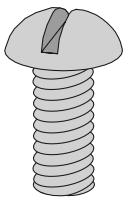

Size	Wt./100 pcs
1/4 x 3/4"	1.3
1/4 x 1"	1.6
1/4 x 1 1/4"	1.9
3/8 x 1"	4.4
3/8 x 1 1/4"	5.0
3/8 x 1 1/2"	5.6

PS 83 – Hexagon Nut

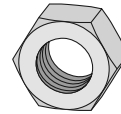

Size	Wt./100	pcs
1/4"	0.7	
3/8"	1.6	
1/2"	3.8	
5/8"	7.3	
3/4"	11.9	

PS 6108 – Square Nut

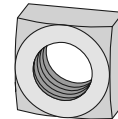

Size	Wt./100 pcs
1/4"	.9
5/16"	1.6
3/8"	2.6
1/2"	5.8

PS 209 – Flat Washer

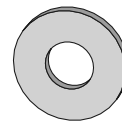

Size	Outside Diameter	Wt./ 100 pcs
1/4"	3/4"	0.7
3/8"	1"	1.5
1/2"	1 3/8"	3.9
5/8"	1 3/4"	7.7
3/4"	2"	11

PS 6112 - Oversize Square Nut

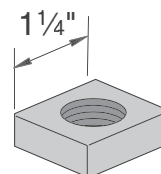

Size	Wt./100 pcs
1/4"-20	13
3/8"-16	14
1/2"-13	14
5/8"-11	12
3/4"-16	11
7/8"-11	10

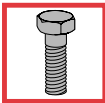

FASTENERS

Finish: Electro-galvanized **Order By:** No. and Size and Finish

PS 230 – Fender Washer

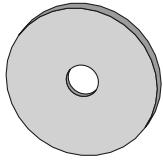

Size	Wt./100 pcs
1/4"	3.3
3/8"	3
1/2"	2.8

PS 211 – Lock Washer

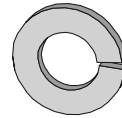

Size	Wt./ 100 pcs
1/4"	0.3
3/8"	0.7
1/2"	1.5

PS 3500 3/8" - 5/8" – Seismic Rod Stiffener

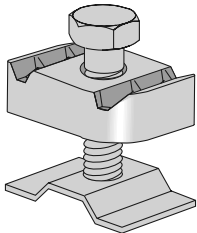

Part No.	Wt./100 pcs
PS 3500 3/8"-5/8"	16

PS 146 – Continuous Thread Rod

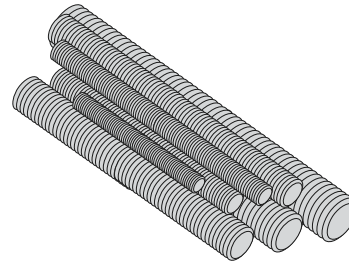

Rod Size	Max Load Lbs.	Wt./100 pcs.	
		6' Lengths	10' Lengths
1/4"	240	73	121
3/8"	610	175	292
1/2"	1,130	319	531
5/8"	1,810	504	840
3/4"	2,710	740	1,234

Finish: Plain or Electro-galvanized

Standard Length: 6' or 10'; Other lengths available

PS 6064 – Square Head Cone Point Set Screw

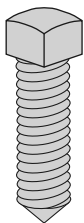

Size	Wt./100 pcs
3/8 x 1 1/2"	4.5
3/8 x 2"	6.1
1/2 x 1 1/2"	8.5
1/2 x 2"	11.4

PS 135 – Rod Coupling

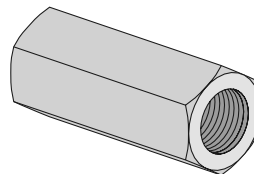

Rod Size	Max Load lbs.	Wt./ 100 pcs.
1/4"	240	2
3/8"	610	9
1/2"	1,130	10
5/8"	1,810	18
3/4"	2,710	28

Hanger rod stiffener assembly for 3/8" thru 5/8" threaded rod.

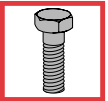

Finish: Electro-galvanized Order By: No. and Size and Finish

PS LS – Clamping Nut with Long Spring

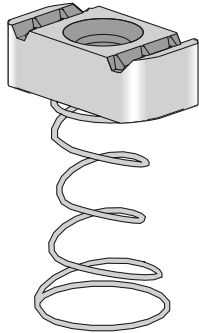

Size	Threads	Wt./100 pcs
1/4"	20	7.5
3/8"	16	10.2
1/2"	13	12.3
5/8"	11	15.8
3/4"	10	14.1

Use With: PS 100 and PS 150 Channel.

PS SS – Clamping Nut with Short Spring

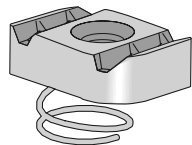

Size	Threads	Wt./100 pcs
#8-32	32	7.0
#10-24	24	7.0
#10-32	32	7.0
1/4"	20	6.9
5/16"	18	6.7
3/8"	16	9.6
1/2"	13*	8.8
5/8"	11*	11.5
3/4"	10*	10.0

Use With: PS 400, PS 500 and PS 520 channel.

*PS SS 1/2" and PS SS 5/8" nuts have 3/8" body thickness.

PS NS – Clamping Nut without Spring

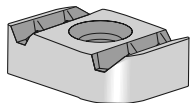

Size	Threads	Wt./100 pcs
#8-32	32*	8.0
#10-32	32*	6.6
#10-24	24*	6.7
1/4"	20*	6.6
5/16"	18*	6.4
3/8"	16*	9.3
1/2"	13	11.4

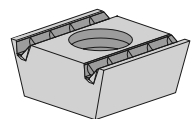

Size	Threads	Wt./100 pcs
5/8"	11	15.2
3/4"	10	13.0
7/8"	9	14.0

Use With: PS 100, PS 150, PS 200, PS 210 and PS 300 channel.

*Can be used with PS 400, PS 500, PS 520 and PS 560 channel.

PS RS – Clamping Nut with Long Spring

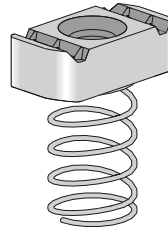

Size	Threads	Wt./100 pcs
#10-24	24	7.2
#10-32	32	7.2
1/4"	20	7.1
5/16"	18	7.0
3/8"	16	9.9
1/2"	13	11.9

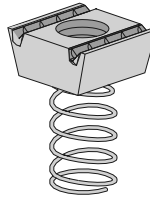

Size	Threads	Wt./100 pcs
5/8"	11	15.5
3/4"	10	13.8
7/8"	9	14.3

Use With: PS 200, PS 210 and PS 300 Channel.

PS 517 – Channel Nut with Stud

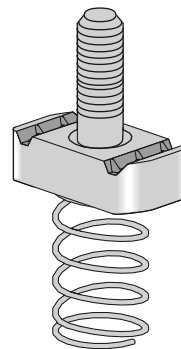

Size	Wt./100 pcs
1/4" x 1"	8.1
1/4" x 1 1/4"	8.3
1/4" x 1 1/2"	8.6
1/4" x 2"	9.1
3/8" x 1"	13.0
3/8" x 1 1/4"	14.0
3/8" x 1 1/2"	14.0
3/8" x 2"	15.0
1/2" x 1"	15.0
1/2" x 1 1/4"	16.0
1/2" x 1 1/2"	17.0
1/2" x 2"	19.0

Use With: PS 200, PS 210 and PS 300 channel.

PS NS S – Shallow Clamping Nut without Spring

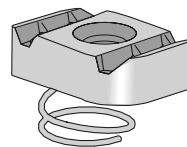

Size	Threads	Wt./100 pcs
1/2"	13	6.9
5/8"	11	9.7
3/4"	10	8.4

Use With: PS 500 and PS 520 channel.

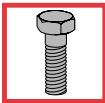

FASTENERS

Finish: Electro-galvanized **Order By:** No. and Size and Finish

PS TG – Top Grip™ Nut

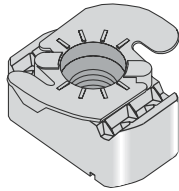

Part No.	Size	Threads	Wt./100 pcs
PSTG 1/4	1/4"	20	7
PSTG 3/8	3/8"	16	10
PSTG 1/2*	1/2"	13	8

Use With: All 1 5/8" Channel.

*PS TG 1/2" nut has a 3/8" body thickness

PS 202 – Eyelet

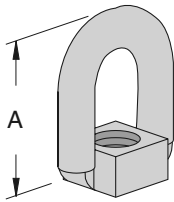

Rod Size	A	Stock Dia.	Max. Load lbs.	Wt./100 pcs
3/8"	1 3/4"	3/8"	610	15
1/2"	1 3/4"	3/8"	610	18

PS 204 – Linked Eyelets

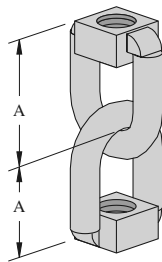

Rod Size	A	Stock Dia.	Max. Load lbs.	Wt./100 pcs
3/8"	1 7/16"	3/8"	610	23
1/2"	1 3/8"	3/8"	610	32

PS 3281 – Double Conveyor Adjusting Nut

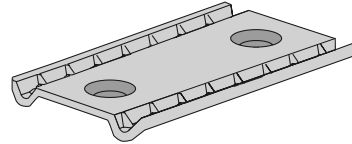

Size	Threads	Wt./100 pcs
3/8"	16	17.5

Use With: All 1 5/8" channel.

PS 205 – Eyelet with Stud

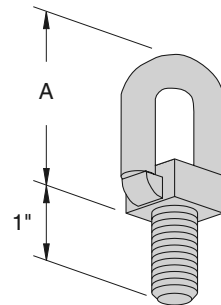

Rod Size	A	Stock Dia.	Max. Load lbs.	Wt./100 pcs
3/8"	1 13/16"	3/8"	610	16
1/2"	1 3/4"	3/8"	610	20

PS 203 – Linked Eyelet with Stud

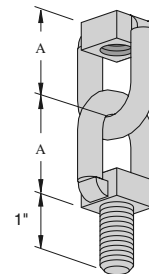

Rod Size	A	Stock Dia.	Max. Load lbs.	Wt./100 pcs
3/8"	1 7/16"	3/8"	610	27
1/2"	1 3/8"	3/8"	610	45

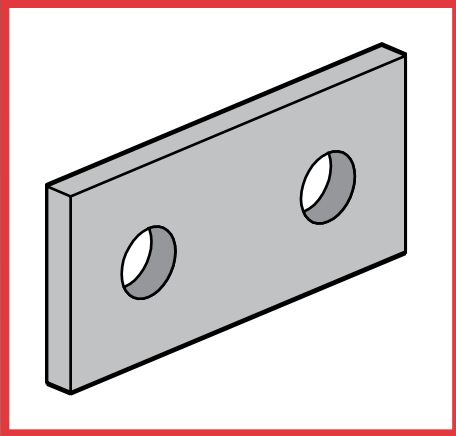

FITTINGS

Power-Strut has a wide variety of fittings to meet all of your application requirements

MATERIAL:

All Power-Strut fittings are formed in punch press dies from mild, pickled and oiled, bar or strip steel. Plain or electro-galvanized fittings meet the requirements for ASTM A575 and A-576, or ASTM A-36.

STANDARD DIMENSIONS:

Standard dimensions on all fittings are as follows except where otherwise indicated:

Fitting Thickness:	1/4"
Fitting Width:	1 5/8"
Hole Diameter:	9/16"
Hole Spacing:	1 7/8" on centers and 1 3/16" from ends.

STANDARD FINISH:

All Power-Strut fittings are available in painted green or electro-galvanized finish.

ORDERING INFORMATION:

When ordering, add the length or size and finish to the part number. See pages 8-10 for finish abbreviations and an example.