

JUNIOR CHANNEL

Power-Strut junior channel sections are cold formed from prime quality cold rolled steel. Junior channel fittings are punched from hot rolled, pickled and oiled steel.

■ STANDARD LENGTHS:

Standard length is 10 feet at a tolerance of $\pm 1/16$ inches. Shorter lengths are available for a small cutting charge.

■ STANDARD DIMENSIONS FOR FITTINGS:

Fitting Thickness: $1/8$ "
Fitting Width: $13/16$ "
Hole Diameter: $9/32$ "
Hole Spacing: $1 1/16$ " on centers and $13/32$ " from end.

■ STANDARD FINISH:

PS 600J and PS 700J junior channels are available in a galvanized or painted green finish. All junior channel fittings are available in electro-galvanized finish.

■ ORDERING INFORMATION:

When ordering, add the length or size and finish to the part number. See pages 8-10 for finish abbreviations and an example.

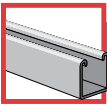

JUNIOR CHANNEL

Finish: Electro-galvanized Stock Width: $1\frac{3}{16}$ " Stock Thickness: $\frac{1}{8}$ " Stock Length: 10 feet Order By: Part No. and Size
 Hole Spacing: $1\frac{3}{32}$ " from end, $1\frac{1}{16}$ " on center Hole Diameter: $\frac{9}{32}$ "

PS 600J – Channel ($1\frac{3}{16}$ " x $1\frac{3}{16}$ " x 19 ga.)

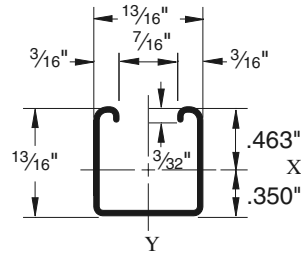
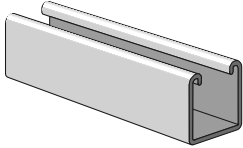

BEAM LOADING DATA – PS 600J CHANNEL

Span In	Max Defl. at		Uniform Loading at Deflection		
	Allowable Uniform Load Lbs	Uniform Load In	Span/180 Lbs	Span/240 Lbs	Span/360 Lbs
18	220	0.06	220	220	170
24	170	0.11	170	150	100
30	130	0.18	130	90	60
36	110	0.26	90	70	40
42	100	0.35	60	50	30
48	80	0.45	50	40	20
54	70	0.58	40	30	20
60	70	0.71	30	20	20

COLUMN LOADING DATA – PS 600J CHANNEL

Unbraced Height In	Maximum Allowable Load at Slot Face Lbs	Maximum Column Load Applied at C.G.			
		K = 0.65 Lbs	K = 0.80 Lbs	K = 1.0 Lbs	K = 1.2 Lbs
18	570	1,650	1,340	960	670
24	450	1,210	840	540	370
30	340	820	540	350	240
36	270	570	370	240	170
42	210	420	280	180	120
48	170	320	210	130	90
54	140	250	170	110	**
60	120	200	130	**	**

Column loads are for allowable axial loads and must be reduced for eccentric loading. For concentrated load at center of span, divide uniform load by 2 and multiply corresponding deflection by 0.8. This load table is based on a solid channel section.

ELEMENTS OF SECTION

Weight (lbs./100 ft.)	Area of Section (Inch ²)	X-X Axis			Y-Y Axis		
		Moment of Inertia (Inch ⁴)	Section Modulus (Inch ³)	Radius of Gyration (Inch)	Moment of Inertia (Inch ⁴)	Section Modulus (Inch ³)	Radius of Gyration (Inch)
35	0.103	.009	.020	.294	.012	.028	.333

JUNIOR CHANNEL

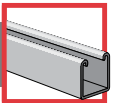

Finish: Electro-galvanized Stock Width: $1\frac{3}{16}$ " Stock Thickness: $\frac{1}{8}$ " Stock Length: 10 feet Order By: Part No. and Size
Hole Spacing: $1\frac{3}{32}$ " from end, $1\frac{1}{16}$ " on center Hole Diameter: $\frac{9}{32}$ "

PS 700J – Channel ($1\frac{3}{16}$ " x $1\frac{3}{32}$ " x 19 ga.)

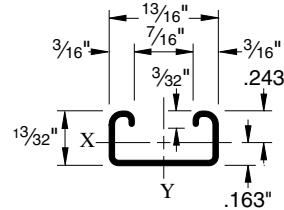
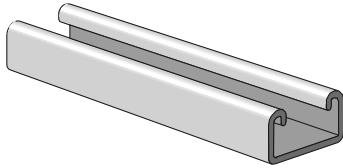

BEAM LOADING DATA – PS 700J CHANNEL

Span In	Max Allowable	Defl. at	Uniform Loading at Deflection		
	Uniform Load Lbs	Uniform Load In	Span/180 Lbs	Span/240 Lbs	Span/360 Lbs
18	80	0.10	80	60	40
24	60	0.18	40	30	20
30	50	0.28	30	20	10
36	40	0.40	20	10	10

COLUMN LOADING DATA – PS 700J CHANNEL

Unbraced Height In	Maximum Allowable Load at Slot Face Lbs	Maximum Column Load Applied at C.G.			
		K = 0.65 Lbs	K = 0.80 Lbs	K = 1.0 Lbs	K = 1.2 Lbs
18	320	970	720	470	330
24	230	620	410	260	180
30	170	400	260	**	**
36	130	280	180	**	**

Column loads are for allowable axial loads and must be reduced for eccentric loading. For concentrated load at center of span, divide uniform load by 2 and multiply corresponding deflection by 0.8. This load table is based on a solid channel section.

ELEMENTS OF SECTION

Weight (lbs./100 ft.)	Area of Section (Inch ²)	X-X Axis			Y-Y Axis		
		Moment of Inertia (Inch ⁴)	Section Modulus (Inch ³)	Radius of Gyration (Inch)	Moment of Inertia (Inch ⁴)	Section Modulus (Inch ³)	Radius of Gyration (Inch)
24	0.072	0.002	0.007	0.148	0.007	0.017	0.306

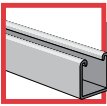

JUNIOR CHANNEL

Finish: Electro-galvanized Stock Width: $1\frac{3}{16}$ " Stock Thickness: $\frac{1}{8}$ " Stock Length: 10 feet Order By: Part No. and Size
 Hole Spacing: $1\frac{3}{32}$ " from end, $1\frac{1}{16}$ " on center Hole Diameter: $\frac{9}{32}$ "

PS 3017 – Junior Channel Nuts

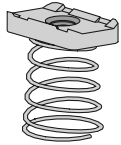

Size	Wt./100 pcs
8-32	1
10-32	1
10-24	1
$\frac{1}{4}$ "	1

Use With: PS 600J channel

PS 4017 – Junior Channel Nuts

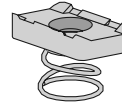

Size	Wt./100 pcs
8-32	1
10-32	1
10-24	1
$\frac{1}{4}$ "	1

Use With: PS 700J channel

PS 2013 – Square Washer

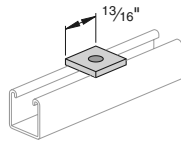

Weight/100 pcs: 2 lbs.

PS 2014 – Two-Hole Splice Plate

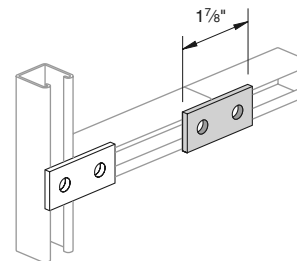

Weight/100 pcs: 5 lbs.

PS 2015 – Three-Hole Splice Plate

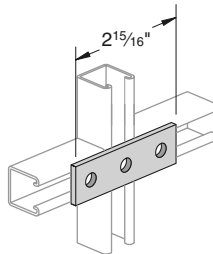

Weight/100 pcs: 8 lbs.

PS 2016 – Four-Hole Splice Plate

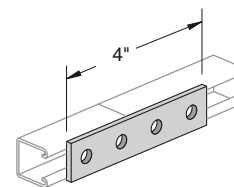

Weight/100 pcs: 11 lbs.

PS 2033 – Flat Angle Plate

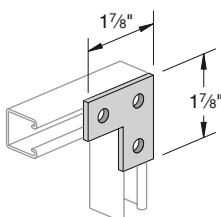

Weight/100 pcs: 8 lbs.

PS 2034 – Tee Plate

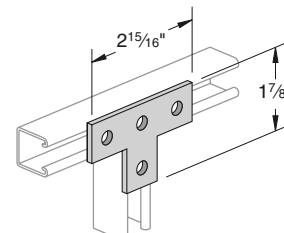

Weight/100 pcs: 11 lbs.

JUNIOR CHANNEL

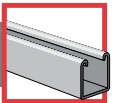

Finish: Electro-galvanized Stock Width: $1\frac{3}{16}$ " Stock Thickness: $\frac{1}{8}$ " Stock Length: 10 feet Order By: Part No. and Size
Hole Spacing: $1\frac{3}{32}$ " from end, $1\frac{1}{16}$ " on center Hole Diameter: $\frac{9}{32}$ "

PS 2008 – Two-Hole Corner Angle

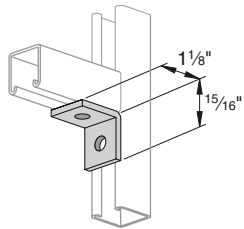

Weight/100 pcs: 5 lbs.

PS 2017 – Two-Hole Corner Angle

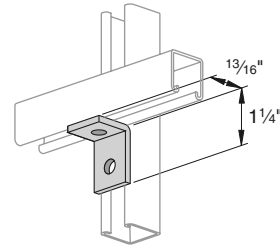

Weight/100 pcs: 5 lbs.

PS 2018 – Three-Hole Corner Angle

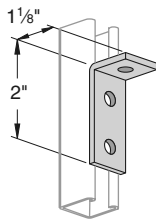

Weight/100 pcs: 8 lbs.

PS 2025 – Three-Hole Corner Angle

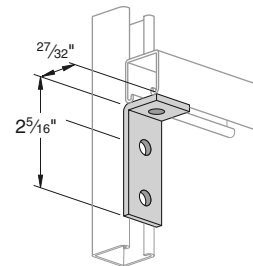

Weight/100 pcs: 8 lbs.

PS 2037 – Three-Hole Corner Angle

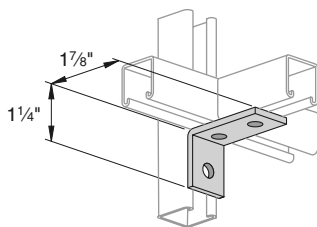

Weight/100 pcs: 8 lbs.

PS 2019 – Four-Hole Corner Angle

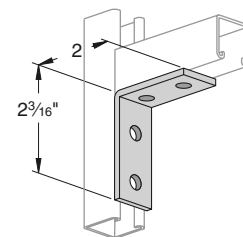

Weight/100 pcs: 11 lbs.

PS 2024 – Four-Hole Corner Angle

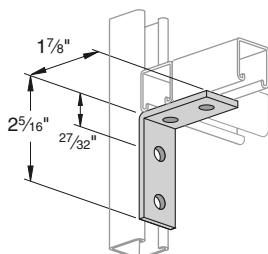

Weight/100 pcs: 11 lbs.

PS 2023 R or L – Four-Hole Shelf Bracket

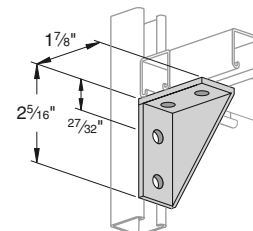

Note: Specify R (right) or L (left) when ordering
Right Hand Illustrated

Weight/100 pcs: 19 lbs.

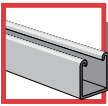

JUNIOR CHANNEL

Finish: Electro-galvanized **Stock Width:** $1\frac{3}{16}$ " **Stock Thickness:** $\frac{1}{8}$ " **Stock Length:** 10 feet **Order By:** Part No. and Size
Hole Spacing: $1\frac{3}{32}$ " from end, $1\frac{1}{16}$ " on center **Hole Diameter:** $\frac{9}{32}$ "

PS 2010 – Zee Support

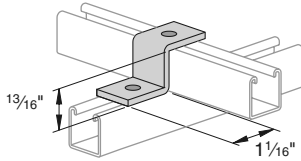

Use With: PS 600J

Weight/100 pcs: 7 lbs

PS 2011 – "U" Support

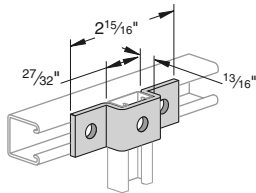

Use With: PS 600J

Weight/100 pcs: 12 lbs.

PS 2026 – Zee Support

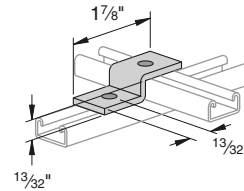

Use With: PS 700J

Weight/100 pcs: 6 lbs.

PS 2029 – End Cap

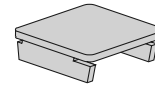

Use With: PS 600J

Weight/100 pcs: 2 lbs.

PS 2041 – Tubing Clamps

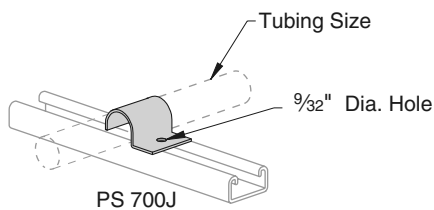

PS 700J

Size Tubing O.D.	Wt./ 100 pcs
$\frac{1}{4}$ "	2
$\frac{3}{8}$ "	2
$\frac{1}{2}$ "	2
$\frac{5}{8}$ "	2
$\frac{3}{4}$ "	3
$\frac{7}{8}$ "	3
1"	3

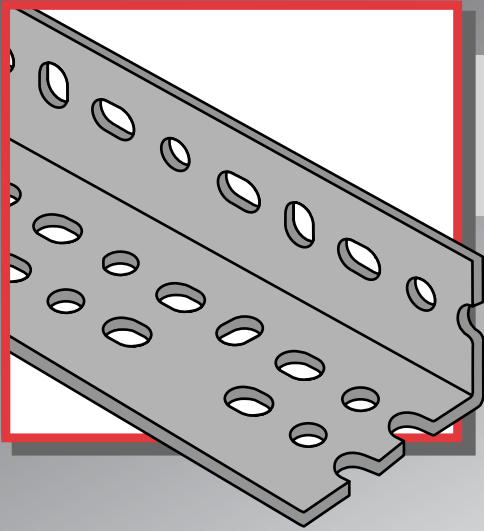

POWER-ANGLE®

A complete support system that's versatile, economical and easy to use.

- *No drilling, welding or special tools necessary*
- *Fast, efficient bolt-together construction*
- *Easy to change and adjust*

■ STANDARD LENGTHS:

Standard lengths are 10' and 12'. Slotted angle is shipped in ten-piece bundles complete with 75 pieces of $\frac{3}{8}$ " - 16 x $\frac{3}{4}$ " hex head bolts and $\frac{3}{8}$ " nuts.

■ STANDARD FINISH:

Available in two durable, long-lasting finishes; pre-galvanized or Power-Green™.

■ ORDERING INFORMATION:

When ordering, add the length or size and finish to the part number. See pages 8-10 for finish abbreviations and an example.