

PIPE & CONDUIT CLAMPS

Power-Strut pipe, conduit and O.D. tubing clamps are formed in punch press dies in a wide selection of sizes to meet every requirement.

MATERIAL:

Power-Strut pipe, conduit and O.D. tubing clamps are made on punch press dies from hot rolled, pickled and oiled steel which conforms to the ASTM A-1008, A-1011 SS, A-575 and A-576 standards. Select sizes of O.D. tubing clamps are available in stainless steel or aluminum.

STANDARD FINISH:

All steel clamps are electro-galvanized. Select sizes of O.D. tubing clamps are available in copper plated finish. PVC coatings are available upon special request.

ORDERING INFORMATION:

When ordering, add the length or size and finish to the part number. See pages 8-10 for finish abbreviations and an example.

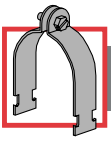

PIPE & CONDUIT CLAMPS

Finish: Electro-galvanized Order By: No. and Finish

PS 1000 – EMT Conduit Clamp

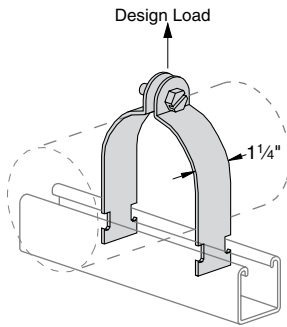

NOTE: For EMT larger than 2" use PS 1100

EMT Size	Stock Thickness	Hanging Load Rating/lbs.	Wt./ 100 pcs
1/2"	.060	400	11
3/4"	.060	400	12
1"	.075	600	15
1 1/4"	.075	600	18
1 1/2"	.105	800	29
2"	.105	800	33

PS 1300 – Universal Clamp for EMT, IMC & GRC

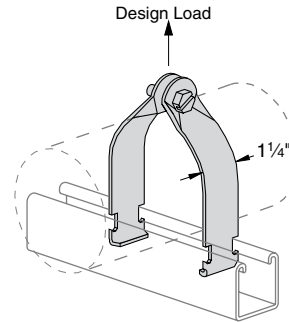

Nom Size	Fits O.D.	Stock Thickness	Hanging Load Rating/lbs.	Wt./ 100 pcs
1/2"	.706-.840	.060	250	10
3/4"	.922-1.050	.060	400	11
1"	1.163-1.315	.060	400	12
1 1/4"	1.510-1.660	.075	400	18
1 1/2"	1.740-1.900	.075	500	20
2"	2.197-2.375	.075	500	22

PS 1100, PS 1116, PS 1117 – Standard Pipe Clamp (GRC, IMC and SCH 40/SCH 80 steel pipe)

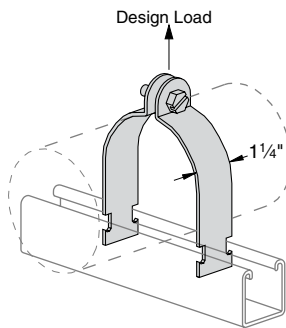

Material and finish are specified as:

- 1100 ALM** .. Alum. clamp, EG fasteners
- 1100 HDG** .. HDG Clamp, Stainless Steel fasteners
- 1116** Alum. clamp and fasteners
- 1117** Alum. clamp, Stainless Steel fasteners
- 1100SS** Stainless Steel clamp and fasteners

Pipe Size	Stock Thickness	Hanging Load Rating/lbs.	Wt./ 100 pcs
3/8"	.060	400	10
1/2"	.060	400	11
3/4"	.075	600	15
1"	.075	600	17
1 1/4"	.075	600	19
1 1/2"	.105	800	29
2"	.105	800	34
2 1/2"	.105	800	40
3"	.105	800	47
3 1/2"	.125	1,000	62
4"	.125	1,000	67
5"	.125	1,000	80
6"	.135	1,000	102
8"	.135	1,000	130
10"	.135	1,000	143
12"	.135	1,000	174

PIPE & CONDUIT CLAMPS

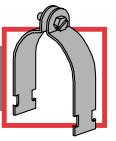

Finish: Electro-galvanized Order By: No. and Size

PS 1200 – O.D. Tubing Clamp

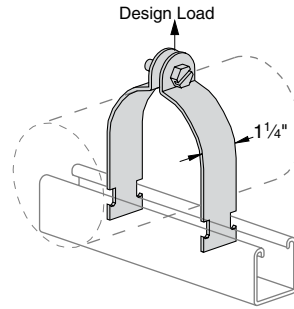

O.D. Size	Stock Thickness	Hanging Load Rating/lbs.	Wt./ 100 pcs	Other Finishes Available	
1/4"	.060	400	8		
3/8"	.060	400	8	CPLT	
1/2"	.060	400	9	CPLT	
5/8"	.060	400	10	CPLT	
3/4"	.060	400	11		
7/8"	.060	400	12	CPLT	
1"	.075	600	14		
1 1/8"	.075	600	15	SS	CPLT
1 1/4"	.075	600	16	SS	
1 3/8"	.075	600	17	SS	CPLT
1 1/2"	.075	600	18	SS	
1 5/8"	.075	600	19	SS	CPLT
1 3/4"	.105	800	29	SS	
1 7/8"	.105	800	28	SS	
2"	.105	800	31	SS	
2 1/8"	.105	800	32	SS	CPLT
2 1/4"	.105	800	33	SS	
2 3/8"	.105	800	34	SS	
2 1/2"	.105	800	35	SS	
2 5/8"	.105	800	37	SS	CPLT
2 3/4"	.105	800	38	SS	
2 7/8"	.105	800	40	SS	
3"	.105	800	41	SS	
3 1/8"	.105	800	43	SS	CPLT
3 1/4"	.105	800	45	SS	
3 3/8"	.105	800	46	SS	
3 1/2"	.105	800	47	SS	
3 5/8"	.105	800	56	SS	CPLT
3 3/4"	.105	800	58	SS	
3 7/8"	.125	1,000	60	SS	
4"	.125	1,000	62	SS	
4 1/8"	.125	1,000	62	SS	CPLT
4 1/4"	.125	1,000	64	SS	
4 3/8"	.125	1,000	66	SS	
4 1/2"	.125	1,000	67	SS	

O.D. Size	Stock Thickness	Hanging Load Rating/lbs.	Wt./ 100 pcs
4 5/8"	.125	1,000	70
4 3/4"	.125	1,000	72
4 7/8"	.125	1,000	73
5"	.125	1,000	74
5 1/8"	.125	1,000	76
5 1/4"	.125	1,000	77
5 3/8"	.125	1,000	78
5 1/2"	.125	1,000	79
5 5/8"	.135	1,000	88
5 3/4"	.135	1,000	90
5 7/8"	.135	1,000	92
6"	.135	1,000	94
6 1/8"	.135	1,000	96
6 1/4"	.135	1,000	98
6 3/8"	.135	1,000	99
6 1/2"	.135	1,000	100
6 5/8"	.135	1,000	102
6 3/4"	.135	1,000	104
6 7/8"	.135	1,000	106
7"	.135	1,000	108
7 1/8"	.135	1,000	110
7 1/4"	.135	1,000	112
7 3/8"	.135	1,000	114
7 1/2"	.135	1,000	116
7 5/8"	.135	1,000	117
7 3/4"	.135	1,000	119
7 7/8"	.135	1,000	121
8"	.135	1,000	123
8 1/8"	.135	1,000	125
8 1/4"	.135	1,000	126
8 3/8"	.135	1,000	128
8 1/2"	.135	1,000	129
8 5/8"	.135	1,000	130

Please contact factory for sizes not shown.

NOTE: SS - Stainless Steel
CPLT - Copper Plated

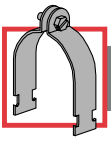

PIPE & CONDUIT CLAMPS

Finish: Electro-galvanized Order By: No. and Finish

PS 3138 – Parallel Run Pipe Clamp

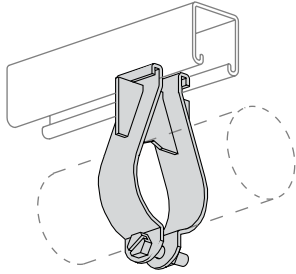

Pipe Size	Load Rating	Wt./ 100 pcs
3/8"	300	27
1/2"	300	29
3/4"	300	30
1"	400	31
1 1/4"	400	38
1 1/2"	500	40
2"	500	47
2 1/2"	500	66
3"	500	78
3 1/2"	500	87
4"	500	90

PS 3126 – One-Piece Pipe Strap

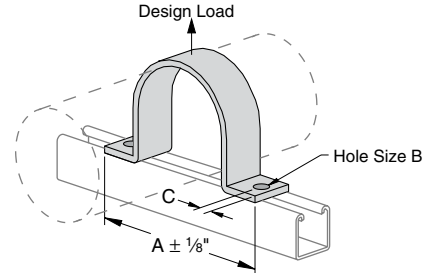

Pipe Size	A	B	C	Design Load	Wt./ 100 pcs
1/2"	2 7/8"	9/32"	7/16"	500	23
3/4"	3 1/8"	9/32"	7/16"	500	26
1"	3 3/8"	9/32"	7/16"	500	31
1 1/4"	3 3/4"	9/32"	7/16"	500	35
1 1/2"	3 7/8"	9/32"	7/16"	500	39
2"	5 3/4"	7/16"	1 1/16"	1,000	94
2 1/2"	6 1/4"	7/16"	1 1/16"	1,000	114
3"	6 7/8"	7/16"	1 1/16"	1,000	133
3 1/2"	7 3/8"	7/16"	1 1/16"	1,000	152
4"	7 7/8"	7/16"	1 1/16"	1,000	176
5"	9"	7/16"	1 1/16"	1,000	198
6"	10"	7/16"	1 1/16"	1,000	225

PS 1450 – One-Hole Clamp for O.D. Tubing

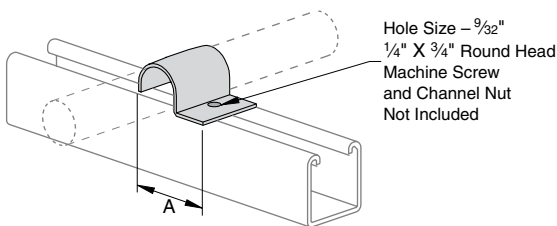

O.D. Size	A	Thickness Gages	Wt./ 100 pcs
1/4"	1 3/16"	16	4
3/8"	1 5/16"	16	5
1/2"	1 7/16"	16	6
5/8"	1 5/8"	14	8
3/4"	1 3/4"	14	9
7/8"	1 7/8"	14	10
1"	2"	14	11

PS 3792 – Power-Wrap™

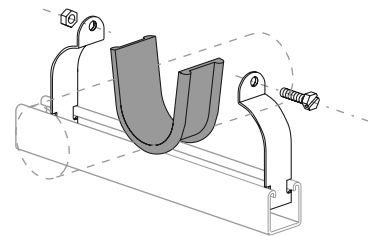

Material: EPDM
Stock Thickness: 1/8"
Stock Length: 25 ft./box
Service Temp: -70° to 350° F

Weight/100 boxes: 253 lbs.

PIPE & CONDUIT CLAMPS

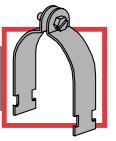

Finish: Electro-galvanized Order By: No. and Size

PS 67 – Pipe or Conduit Hanger

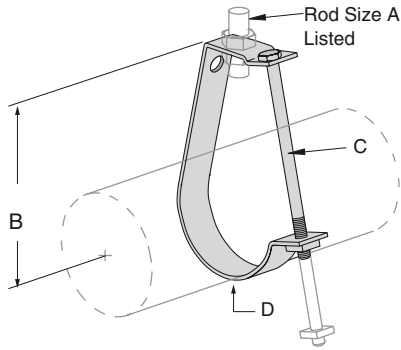

Conduit Size	A Rod Size	B	C	D	Load Rating	Wt./ 100 pcs
1/2"	3/8"	1 3/4"	1/4 x 2 1/4"	1/8 x 3/4"	300	20
3/4"	3/8"	1 7/8"	1/4 x 2 1/4"	1/8 x 3/4"	300	21
1"	3/8"	2 1/4"	1/4 x 2 3/4"	1/8 x 3/4"	300	24
1 1/4"	3/8"	2 3/4"	1/4 x 3 1/4"	1/8 x 3/4"	300	27
1 1/2"	3/8"	3"	1/4 x 3 1/2"	1/8 x 3/4"	300	29
2"	3/8"	3 3/8"	1/4 x 4"	1/8 x 3/4"	300	33
2 1/2"	1/2"	4"	3/8 x 4 1/2"	1/8 x 1 1/4"	500	71
3"	1/2"	4 1/4"	3/8 x 5"	1/8 x 1 1/4"	500	78
3 1/2"	1/2"	4 3/4"	3/8 x 5 1/2"	1/8 x 1 1/4"	500	85
4"	5/8"	5 1/2"	3/8 x 6 1/2"	1/4 x 1 1/4"	600	178
5"	5/8"	6"	3/8 x 7 1/2"	1/4 x 1 1/4"	600	199
6"	3/4"	7"	3/8 x 8 1/2"	1/4 x 1 1/4"	600	231
8"	7/8"	10"	3/8 x 12"	1/4 x 2"	700	449

PS 69 – E-Z Grip Hanger

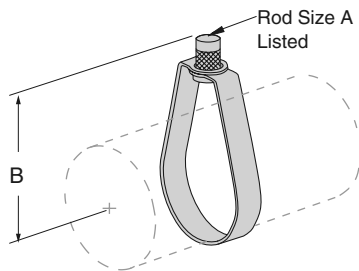

Size	A Rod Size	B	Load Rating Lbs/650	Wt./ 100 pcs
1/2"	3/8"	2 1/4"	300	9
3/4"	3/8"	2 5/16"	300	9
1"	3/8"	2 7/16"	300	10
1 1/4"	3/8"	2 5/8"	300	10
1 1/2"	3/8"	2 3/4"	300	110
2"	3/8"	3 1/4"	300	11
2 1/2"	3/8"	4"	525	25
3"	3/8"	4 3/8"	525	27
4"	3/8"	4 11/16"	600	48
5"	1/2"	5 5/16"	1000	53
6"	1/2"	6 7/16"	1000	100
7"	1/2"	8"	1000	100

PS 51 – Right Angle Pipe or Conduit Clamp

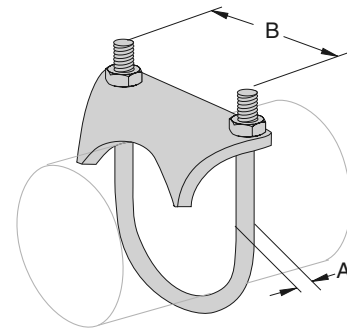

Size	A Diameter	B	Wt./ 100 pcs
3/8"	5/16"	15/16"	25
1/2"	5/16"	1 3/16"	41
3/4"	5/16"	1 7/16"	42
1"	5/16"	1 11/16"	47
1 1/4"	5/16"	2"	54
1 1/2"	5/16"	2 5/16"	57
2"	3/8"	2 3/16"	85
2 1/2"	3/8"	3 3/8"	106
3"	3/8"	4 1/8"	110
3 1/2"	3/8"	4 5/8"	128
4"	3/8"	5 1/8"	140

Material: Malleable Iron

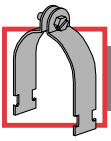

PIPE & CONDUIT CLAMPS

Finish: Electro-galvanized Order By: No. and Finish

PS 004T - PS 106N – Cush-a-Clamp® Assembly Pipe & Tube Series

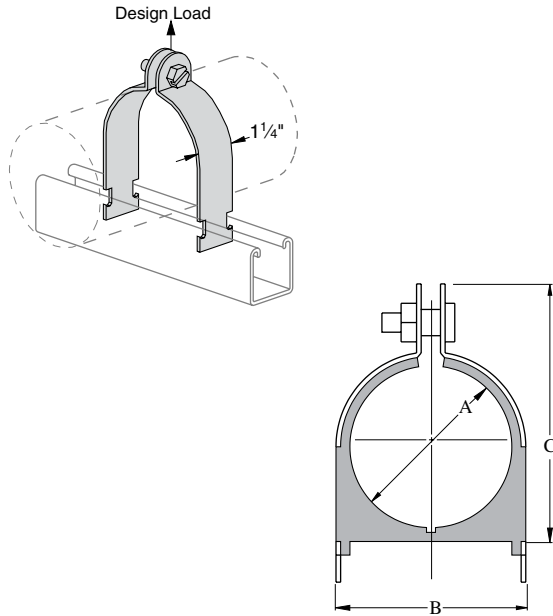

Clamp: Electro-galvanized or stainless steel
 Cushion: Thermoplastic elastomer resistant to the effects of most oils, chemicals and industrial cleaning compounds in temperatures from -50°F to 275°F.
 Includes: Cushion, Clamp and Hardware

Pipe Series

Part No.	Pipe Size (Nominal)	Dimensions			Wt./100
		A	B	C	
PS 009N	1/4"	0.54	0.98	1.34	13
PS 011N	3/8"	0.67	1.13	1.54	14
PS 014N	1/2"	0.84	1.29	1.82	15
PS 017N	3/4"	1.05	1.50	2.08	17
PS 021N	1"	1.31	1.76	2.34	19
PS 027N	1 1/4"	1.66	2.17	2.73	35
PS 030N	1 1/2"	1.90	2.35	2.86	41
PS 038N	2"	2.37	2.82	3.67	49
PS 046N	2 1/2"	2.87	3.32	4.17	57
PS 056N	3"	3.50	3.95	4.79	55
PS 064N	3 1/2"	4.00	4.45	5.42	88
PS 072N	4"	4.50	4.95	5.92	110
PS 089N	5"	5.56	6.01	6.92	130
PS 106N	6"	6.62	7.07	8.23	140

Tube Series

Part No.	Copper & Steel Tube O. D. Size	Copper Water Pipe (Nominal)	Dimensions			Wt./100
			A	B	C	
PS 004T	1/4"		0.25	0.62	0.98	10
PS 006T	3/8"	1/4"	0.37	0.82	1.13	11
PS 008T	1/2"	3/8"	0.50	0.94	1.34	13
PS 010T	5/8"	1/2"	0.62	1.06	1.54	14
PS 012T	3/4"	5/8"	0.75	1.2	1.68	14
PS 014T	7/8"	3/4"	0.87	1.31	1.82	15
PS 016T	1"		1.00	1.44	1.95	17
PS 018T	1 1/8"	1"	1.12	1.57	2.08	18
PS 020T	1 1/4"		1.25	1.70	2.21	18
PS 022T	1 3/8"	1 1/4"	1.37	1.82	2.34	20
PS 024N	1 1/2"		1.50	1.95	2.47	33
PS 026N	1 5/8"	1 1/2"	1.62	2.07	2.60	35
PS 028N	1 3/4"		1.75	2.20	2.73	37
PS 030N	1 7/8"		1.87	2.32	2.86	39
PS 032N	2"		2.00	2.45	3.04	41
PS 034N	2 1/8"		2.12	2.57	3.23	46
PS 038N	2 3/8"		2.37	2.82	3.67	47
PS 040N	2 1/2"		2.50	2.94	3.79	49
PS 042N	2 5/8"		2.62	3.07	3.92	51
PS 046N	2 7/8"		2.87	3.32	4.17	55
PS 048N	3"		3.00	3.57	4.42	57
PS 050N	3 1/8"		3.12	3.57	4.42	60
PS 056N	3 1/2"		3.50	3.95	4.79	55
PS 058N	3 5/8"		3.62	4.2	5.11	70
PS 064N	4"		4.00	4.45	5.42	88
PS 066N	4 1/8"		4.12	4.57	5.54	94
PS 072N	4 1/2"		4.50	4.95	5.92	110
PS 082N	5 1/8"		5.12	5.57	6.54	125
PS 098N	6 1/8"		6.12	6.57	7.54	130

PIPE & CONDUIT CLAMPS

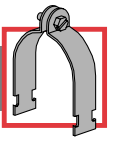

Finish: Electro-galvanized Order By: No. and Size

PS UB 1/2 - PS UB 10 - Cush-a-Clamp® Assembly U-Bolt Series

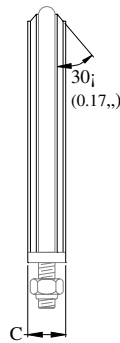
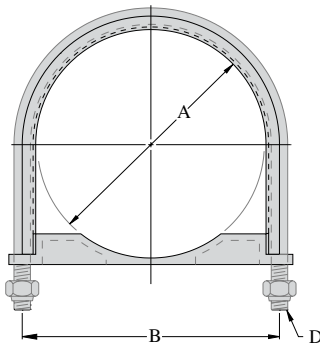
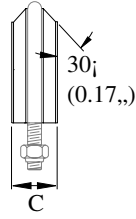
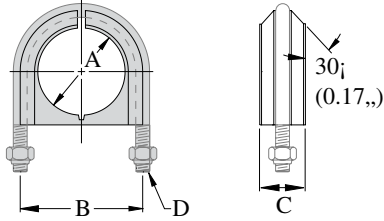

PART NO.	PIPE SIZE	Dimensions				Wt./ 100 Pcs
		A	B	C	D	
PS UB 1/2	1/2"	0.84	1.60	0.68	1/4-20 UNC-2B	9
PS UB 3/4	3/4"	1.05	1.80	0.68	1/4-20 UNC-2B	10
PS UB 1	1"	1.31	2.05	0.68	1/4-20 UNC-2B	12
PS UB 1 1/4	1 1/4"	1.66	2.55	1.24	3/8-16 UNC-2B	32
PS UB 1 1/2	1 1/2"	1.90	2.80	1.24	3/8-16 UNC-2B	36
PS UB 2	2"	2.37	3.35	1.24	3/8-16 UNC-2B	42
PS UB 2 1/2	2 1/2"	2.87	3.90	1.24	1/2-13 UNC-2B	72
PS UB 3	3"	3.50	4.55	1.24	1/2-13 UNC-2B	84
PS UB 3 1/2	3 1/2"	4.00	5.05	1.24	1/2-13 UNC-2B	93
PS UB 4	4"	4.50	5.50	1.24	1/2-13 UNC-2B	102
PS UB 5	5"	5.56	6.56	1.24	1/2-13 UNC-2B	123
PS UB 6	6"	6.62	7.75	1.44	5/8-11 UNC-2B	243
PS UB 8	8"	8.62	9.82	1.44	5/8-11 UNC-2B	293
PS UB 10	10"	10.75	12.16	1.65	3/4-10 UNC-2B	492

Includes U-bolt, cushion, and hardware.

Materials: U-Bolt: Electro-galvanized finish or Type 316 SS

Cushion: Thermoplastic elastomer

Note: Not intended for use with metal framing components due to the length of the thread.

PS 004M - PS 038M - Cush-a-Clamp® Assembly Omega Series

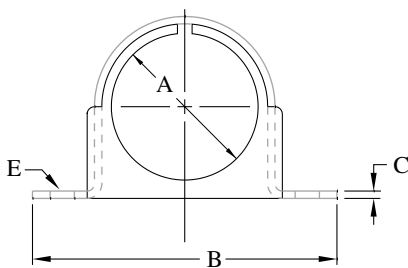
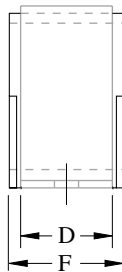
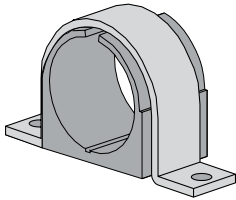

PART NO.	Copper Tubing O.D. SIZE	Water Pipe (Nominal)	Pipe Size (Nominal)	Dimensions						Wt./ 100 Pcs
				A	B	C	D	E	F	
PS 004M	1/4"			0.25	1.81	0.06	0.62	0.20	0.78	3.4
PS 006M	3/8"	1/4		0.37	1.90	0.06	0.62	0.20	0.81	4.0
PS 008M	1/2"	3/8	1/4"	0.50	2.20	0.06	0.75	0.26	0.98	5.5
PS 010M	5/8"	1/2	3/8"	0.62	2.32	0.06	0.75	0.26	0.98	6.0
PS 012M	3/4"	5/8		0.75	2.41	0.06	0.75	0.26	0.98	6.5
PS 014M	7/8"	3/4	1/2"	0.87	2.56	0.06	0.75	0.26	0.98	7.1
PS 016M	1"			1.00	2.68	0.06	0.75	0.26	0.98	7.8
PS 018M20			3/4"	1.05	2.68	0.06	0.75	0.26	0.98	8.1
PS 018M21	1 1/8"	1		1.12	2.82	0.06	0.75	0.26	0.98	8.4
PS 020M	1 1/4"			1.25	3.00	0.08	1.25	0.26	1.56	17
PS 021M			1"	1.31	3.12	0.08	1.25	0.26	1.56	20
PS 022M	1 3/8"	1 1/4		1.37	3.12	0.08	1.25	0.26	1.56	19
PS 024M	1 1/2"			1.50	3.65	0.08	1.25	0.26	1.56	20
PS 026M	1 5/8"	1 1/2		1.62	3.77	0.08	1.25	0.26	1.56	23
PS 027M			1 1/4"	1.66	3.90	0.10	1.25	0.33	1.56	32
PS 028M	1 3/4"			1.75	3.90	0.10	1.25	0.33	1.56	32
PS 030M	1 7/8"		1 1/2"	1.87	4.02	0.10	1.25	0.33	1.56	34
PS 032M	2"			2.00	4.15	0.10	1.25	0.33	1.56	36
PS 034M	2 1/8"			2.12	4.40	0.10	1.25	0.33	1.56	41
PS 038M			2"	2.37	4.71	0.10	1.25	0.33	1.56	44

Includes clamp and cushion.

Materials: Clamp: ZD or Stainless Steel

Cushion: Thermoplastic elastomer

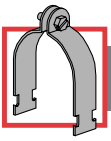

PIPE & CONDUIT CLAMPS

Finish: Electro-galvanized Order By: No. and Finish

PS 3101 thru PS 3115 – One-Piece cable & Conduit Clamp

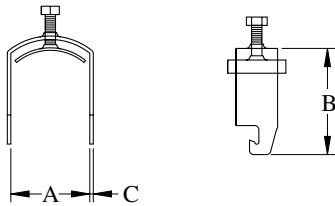
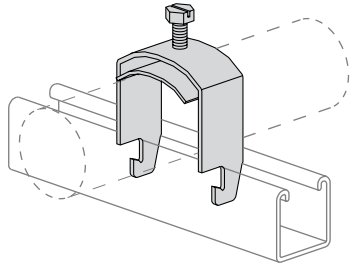

Part No.	Max O.D. Size	A	B	C	Wt/ 100 pcs
PS 3101	3/8"	7/16"	1 5/8"	14	6
PS 3102	1/2"	9/16"	1 3/4"	14	7
PS 3103	3/4"	1 3/16"	2"	14	12
PS 3104	1"	1 1/16"	2 1/4"	14	15
PS 3105	1 1/4"	1 5/16"	2 1/2"	14	19
PS 3106	1 1/2"	1 9/16"	2 3/4"	14	20
PS 3107	1 3/4"	1 13/16"	3"	12	25
PS 3108	2"	2 1/16"	3 1/4"	12	35
PS 3109	2 3/8"	2 7/16"	3 5/8"	12	41
PS 3110	2 3/4"	2 13/16"	4"	12	60
PS 3111	3 1/4"	3 5/16"	4 1/2"	12	74
PS 3112	3 3/4"	3 13/16"	5"	12	91
PS 3113	4"	4 1/16"	5 1/4"	12	100
PS 3114	4 3/8"	4 7/16"	5 5/8"	12	115
PS 3115	4 3/4"	4 13/16"	6"	12	125

Note: Available in Electro-galvanized steel, Type 304 Stainless Steel or Aluminum

PS 270 – Conduit Clamp

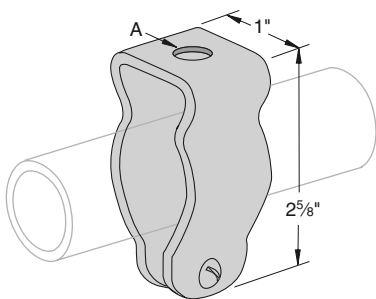

Size	A Diameter	Wt./ 100 pcs
3/8"	1/4"	6
1/2"	1/4"	6
3/4"	1/4"	8
1"	1/4"	9
1 1/4"	1/4"	11
1 1/2"	1/4"	19
2"	1/4"	27

PS 52E – Parallel Pipe and Conduit Clamp

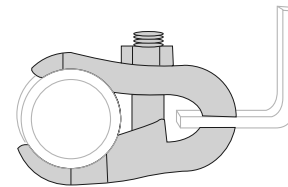

Size	Wt./100 pcs
1/2"	59
3/4"	64
1"	70
1 1/4"	72
1 1/2"	93
2"	128
2 1/2"	135
3"	155
3 1/2"	190
4"	205

Material: Malleable Iron

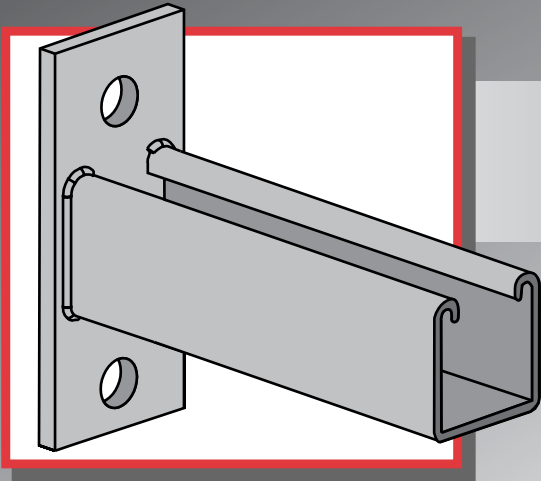

BRACKETS

Power-Strut channel brackets feature a combination fitting and channel to eliminate field fabrication and speed installation. Shelf, pipe and stair brackets are also available in a variety of sizes.

■ MATERIAL:

Power-Strut brackets are made by punch press and roll form operations from hot rolled, mild steel.

■ STANDARD FINISH:

Power-Strut brackets are available in painted green or electro-galvanized finishes.

■ ORDERING INFORMATION:

When ordering, add the length or size and finish to the part number. See pages 8-10 for finish abbreviations and an example.