

## ROLLERS

*Power-Strut rollers feature cast iron rollers and steel brackets formed by punch press dies. The brackets have holes for attachment to channel with a standard channel nut and bolt.*

---

### **MATERIAL:**

Power-Strut pipe rollers consist of cast iron rollers and steel brackets. The steel brackets are punched from hot rolled, pickled and oiled mild steel.

---

### **STANDARD FINISH:**

Standard finish for the roller is plain white brackets are painted green or electro-galvanized.

---

### **ORDERING INFORMATION:**

When ordering, add the length or size and finish to the part number. See pages 8-10 for finish abbreviations and an example.

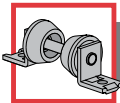

# ROLLERS

Order By: No. and Finish

## PS 1901 – Two-Piece Pipe Roller

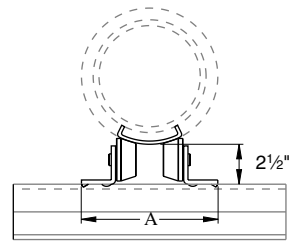
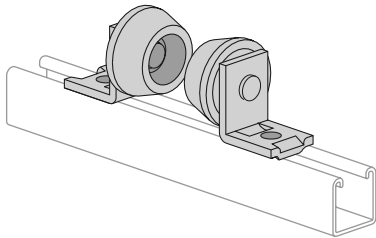

Chart for Dimension A

Pipe Size	No Insulation	Insulation Thickness					
		1"	1 1/2"	2"	2 1/2"	3"	4"
1/2"	6 1/2"	6 1/2"					
3/4"	6 1/2"	6 1/2"	6 5/8"	6 7/8"			
1"	6 1/2"	6 1/2"	6 5/8"	6 7/8"			
1 1/4"	6 1/2"	6 1/2"	6 7/8"	7 1/8"	7 3/8"		
1 1/2"	6 1/2"	6 1/2"	6 7/8"	7 1/8"	7 3/8"		
2"	6 1/2"	6 5/8"	7 1/8"	7 3/8"	7 1/2"	8"	
2 1/2"	6 1/2"	6 5/8"	7 1/8"	7 3/8"	7 1/2"	8"	
3"	6 1/2"	7"	7 1/2"	7 3/4"	7 7/8"	8 1/8"	
3 1/2"	6 1/2"	7"	7 1/2"	7 3/4"	7 7/8"	8 1/8"	
4"	6 5/8"	7 1/4"	7 5/8"	7 7/8"	8"	8 3/8"	9"

Use With: 1/2"-4" pipe

Load Rating: 500 lbs.

Material: Bracket - steel;  
 Roller - cast iron (or aluminum)  
 Finish: Green or galvanized;  
 Roller - plain

Weight/100 pair: 268 lbs.

## PS 815 – Two-Piece, Heavy Duty Pipe Roller

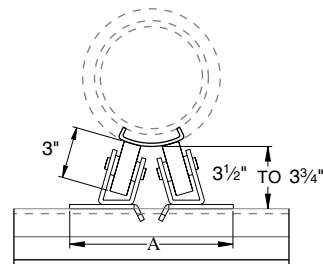
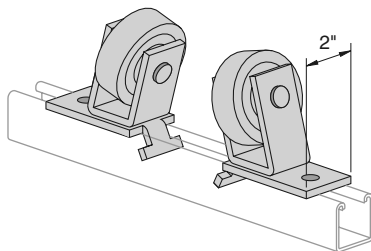

Chart for Dimension A

Pipe Size	No Insulation	Insulation Thickness					
		1"	1 1/2"	2"	2 1/2"	3"	4"
6"	9 1/2"	10 1/4"	10 1/2"	10 3/4"	11"	11 3/8"	11 7/8"
8"	10 1/8"		11"	11 3/8"	11 3/4"	12"	12 1/2"
10"	10 3/4"		11 5/8"	12"	12 1/4"	12 1/2"	13"
12"	11 1/4"		12 1/8"	12 1/2"	12 3/4"	13"	13 1/2"
14"	11 5/8"		12 1/2"	12 7/8"	13"	13 3/8"	14"
16"	12 1/8"		13"	13 3/8"	13 3/8"	14"	14 1/2"

Use With: 6-16" pipe

Material: Bracket - steel;  
 Roller - cast iron

Finish: Green or galvanized;  
 Roller - plain

Load Rating: 1500 lbs.

Weight/100 pair: 680 lbs.

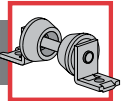

## PS 1902 – Pipe-Roller Assembly

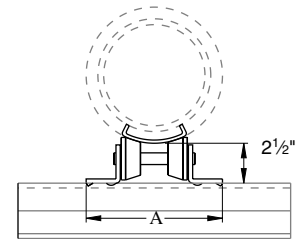
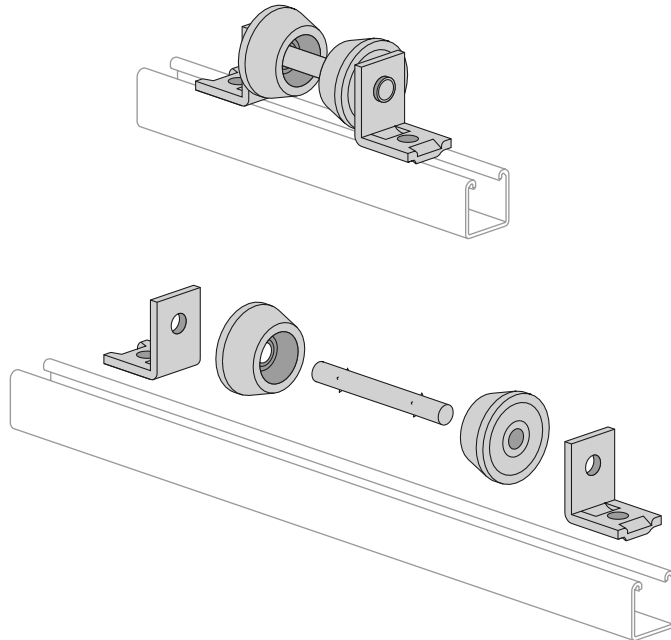

Part Number	A Wt./100 pcs.	
PS 1902 - 1"-2"	6 <sup>3</sup> / <sub>4</sub>	299
PS 1902 - 2 <sup>1</sup> / <sub>2</sub> "-3 <sup>1</sup> / <sub>2</sub> "	7 <sup>1</sup> / <sub>2</sub>	304
PS 1902 - 4"-6"	8 <sup>1</sup> / <sub>2</sub>	311
PS 1902 - 8"	9 <sup>9</sup> / <sub>16</sub>	319

Material: Brackets and shaft - steel;  
Rollers - cast iron

Finish: Brackets - painted green or galvanized;  
Shaft - electro-galvanized;  
Rollers - plain

Load Rating: 750 lbs.

Pipe Size	No Insulation	Insulation Thickness						
		1"	1 <sup>1</sup> / <sub>2</sub> "	2"	2 <sup>1</sup> / <sub>2</sub> "	3"	4"	
1/2"	PS 1902 - 1"-2"	PS 1902 - 1"-2"	PS 1902 - 1"-2"	PS 1902 - 2 <sup>1</sup> / <sub>2</sub> "-3 <sup>1</sup> / <sub>2</sub> "				
3/4"	PS 1902 - 1"-2"	PS 1902 - 1"-2"	PS 1902 - 1"-2"	PS 1902 - 2 <sup>1</sup> / <sub>2</sub> "-3 <sup>1</sup> / <sub>2</sub> "				
1"	PS 1902 - 1"-2"	PS 1902 - 1"-2"	PS 1902 - 1"-2"	PS 1902 - 2 <sup>1</sup> / <sub>2</sub> "-3 <sup>1</sup> / <sub>2</sub> "				
1 <sup>1</sup> / <sub>4</sub> "	PS 1902 - 1"-2"	PS 1902 - 1"-2"	PS 1902 - 1"-2"	PS 1902 - 2 <sup>1</sup> / <sub>2</sub> "-3 <sup>1</sup> / <sub>2</sub> "				
1 <sup>1</sup> / <sub>2</sub> "	PS 1902 - 1"-2"	PS 1902 - 1"-2"	PS 1902 - 2 <sup>1</sup> / <sub>2</sub> "-3 <sup>1</sup> / <sub>2</sub> "	PS 1902 - 2 <sup>1</sup> / <sub>2</sub> "-3 <sup>1</sup> / <sub>2</sub> "	PS 1902 - 2 <sup>1</sup> / <sub>2</sub> "-3 <sup>1</sup> / <sub>2</sub> "			
2"	PS 1902 - 1"-2"	PS 1902 - 1"-2"	PS 1902 - 2 <sup>1</sup> / <sub>2</sub> "-3 <sup>1</sup> / <sub>2</sub> "	PS 1902 - 2 <sup>1</sup> / <sub>2</sub> "-3 <sup>1</sup> / <sub>2</sub> "	PS 1902 - 2 <sup>1</sup> / <sub>2</sub> "-3 <sup>1</sup> / <sub>2</sub> "			
2 <sup>1</sup> / <sub>2</sub> "	PS 1902 - 1"-2"	PS 1902 - 1"-2"	PS 1902 - 2 <sup>1</sup> / <sub>2</sub> "-3 <sup>1</sup> / <sub>2</sub> "	PS 1902 - 2 <sup>1</sup> / <sub>2</sub> "-3 <sup>1</sup> / <sub>2</sub> "	PS 1902 - 2 <sup>1</sup> / <sub>2</sub> "-3 <sup>1</sup> / <sub>2</sub> "			
3"	PS 1902 - 1"-2"	PS 1902 - 2 <sup>1</sup> / <sub>2</sub> "-3 <sup>1</sup> / <sub>2</sub> "	PS 1902 - 2 <sup>1</sup> / <sub>2</sub> "-3 <sup>1</sup> / <sub>2</sub> "	PS 1902 - 4"-6"	PS 1902 - 4"-6"	PS 1902 - 4"-6"		
3 <sup>1</sup> / <sub>2</sub> "	PS 1902 - 1"-2"	PS 1902 - 2 <sup>1</sup> / <sub>2</sub> "-3 <sup>1</sup> / <sub>2</sub> "	PS 1902 - 2 <sup>1</sup> / <sub>2</sub> "-3 <sup>1</sup> / <sub>2</sub> "	PS 1902 - 4"-6"	PS 1902 - 4"-6"	PS 1902 - 4"-6"		
4"	PS 1902 - 1"-2"	PS 1902 - 2 <sup>1</sup> / <sub>2</sub> "-3 <sup>1</sup> / <sub>2</sub> "	PS 1902 - 2 <sup>1</sup> / <sub>2</sub> "-3 <sup>1</sup> / <sub>2</sub> "	PS 1902 - 4"-6"	PS 1902 - 4"-6"	PS 1902 - 4"-6"		
5"	PS 1902 - 2 <sup>1</sup> / <sub>2</sub> "-3 <sup>1</sup> / <sub>2</sub> "	PS 1902 - 4"-6"	PS 1902 - 4"-6"	PS 1902 - 4"-6"	PS 1902 - 4"-6"	PS 1902 - 8"	PS 1902 - 8"	
6"	PS 1902 - 2 <sup>1</sup> / <sub>2</sub> "-3 <sup>1</sup> / <sub>2</sub> "	PS 1902 - 4"-6"	PS 1902 - 4"-6"	PS 1902 - 4"-6"	PS 1902 - 4"-6"	PS 1902 - 8"	PS 1902 - 8"	
8"	PS 1902 - 2 <sup>1</sup> / <sub>2</sub> "-3 <sup>1</sup> / <sub>2</sub> "	PS 1902 - 4"-6"	PS 1902 - 8"	PS 1902 - 8"	PS 1902 - 8"	PS 1902 - 8"	PS 1902 - 8"	

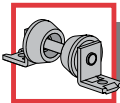

# ROLLERS

Order By: No. and Finish

## PS 1911 – Pipe Roller

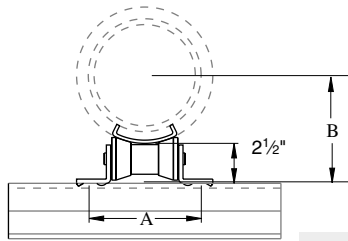
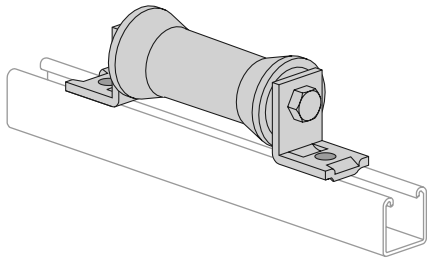

Size	Fits		Wt./ 100 pcs	
	Pipe Size	A		B
2 – 3½"	2"	5"	3"	160
	2½"	5"	3¼"	
	3"	5"	3⅝"	
4 – 6"	3½"	5"	3⅞"	215
	4"	5⅞"	4⅝"	
	5"	5⅞"	4⅞"	
8 – 10"	6"	5⅞"	5⅞"	525
	8"	8⅝"	7⅞"	
	10"	8⅝"	8¼"	
12 – 14"	12"	10⅞"	9⅞"	1,025
	14"	10⅞"	10½"	

Material: Brackets and shaft - steel; Rollers - cast iron

Finish: Brackets - painted green or galvanized;  
Shaft - electro-galvanized; Rollers - plain

Load Rating: 950 lbs.

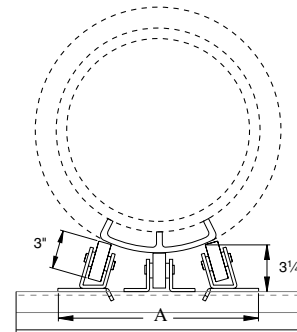
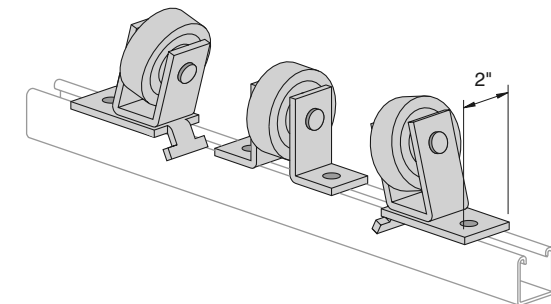

Use With: 16-24" pipe

Material: Brackets - steel; Roller - cast iron

Finish: Brackets - painted green or galvanized;  
Roller - plain

Load Rating: 2,000 lbs.

### Chart for Dimension A

Pipe Size	Insulation Thickness				
	1½"	2"	2½"	3"	4"
16"			13⅞"	14"	14½"
18"	13⅝"	14"	14⅞"	14½"	15"
20"	14⅞"	14½"	14¾"	15"	15½"
24"	15¼"	15½"	15⅞"	16⅞"	16⅝"

Weight/100 units: 1,046 lbs.

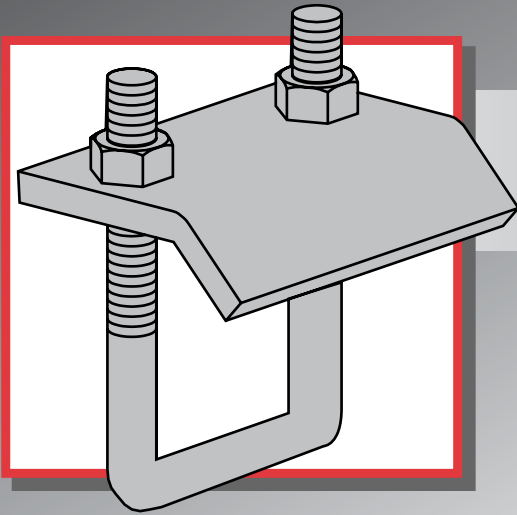

## BEAM CLAMPS

*Power-Strut offers beam clamps designed for every loading condition from light to heavy duty. Styles are available to attach to nearly every type of support beam.*

---

### **MATERIAL:**

Power-Strut beam clamps are cold formed from hot rolled, pickled and oiled steel. Square head, cone point set screws are furnished where noted. Cast beam clamps are made from high quality malleable iron.

---

### **STANDARD FINISH:**

Standard finish is plain or electro-galvanized.

---

### **ORDERING INFORMATION:**

When ordering, add the length or size and finish to the part number. See pages 8-10 for finish abbreviations and an example.